

# CLOUD PANEL INSTALLATION GUIDE

## DIRECT FIX for frameless panels

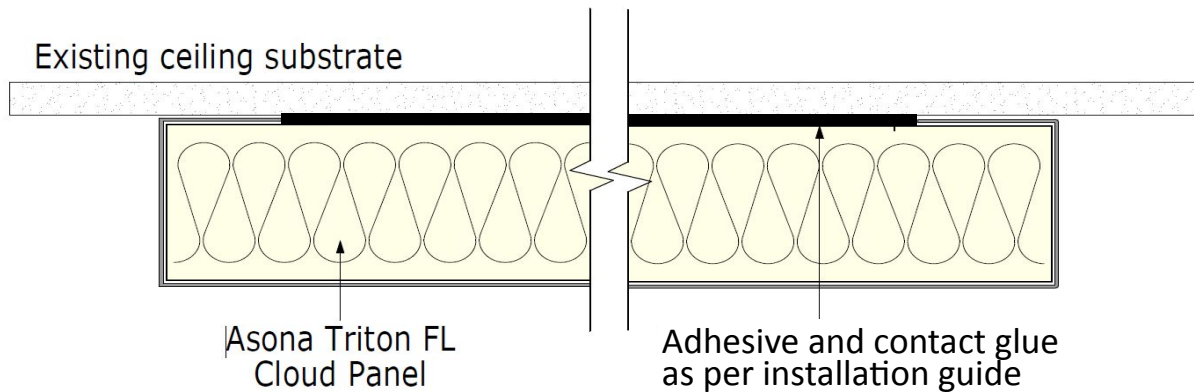

asona



The following guidelines are given to help avoid common errors. They are not intended to be a step-by-step list of instructions or a checklist, and it is assumed that the installer has general construction knowledge. Asona bears no responsibility for any installation actions taken or not taken, and is not responsible for installer selection.

### HANDLING & STORAGE

Handle individual panels 'on edge' to avoid bending when moving and carrying. Store panels on a flat, dry solid surface. Do not store on edge. Take necessary measures to keep panels dry, clean and free from dust. Pay special attention to edges. Use gloves when handling panels to avoid marking.

### INSTALLATION

1. The ceiling surface must be dry and free from dirt, dust, grease, loose paint, or any foreign matter that would interfere with a good adhesive bond. If the ceiling surface is not reasonably flat then panel alignment will be compromised.
2. Measure lines on ceiling keeping lines plumb and square to create panel locations on the ceiling.
3. Installers of Asona products have successfully used the following construction mastics: Sikaflex Polyurethane Adhesive, Fullers Max Bond or Bostik Extreme. (This is not a product endorsement).

4. 50 -75 mm in from the panel edges, run a 10 mm bead of construction adhesive around the perimeter of the panel and then at 150 mm centres through out the field of the panel. Infill spaces with HSEA spray applied contact adhesive and reflect the same pattern to the substrate above with the contact glue. Alternatively apply a continuous layer of construction adhesive to the rear of the panel with a 6 mm notched trowel.
5. Place panel into position, press panel carefully and evenly.

**NB:** Cloud Panel tolerance is +/- 3mm. Do not butt-up panels, we recommend a minimum gap of 10mm between direct fixed panels when installed.

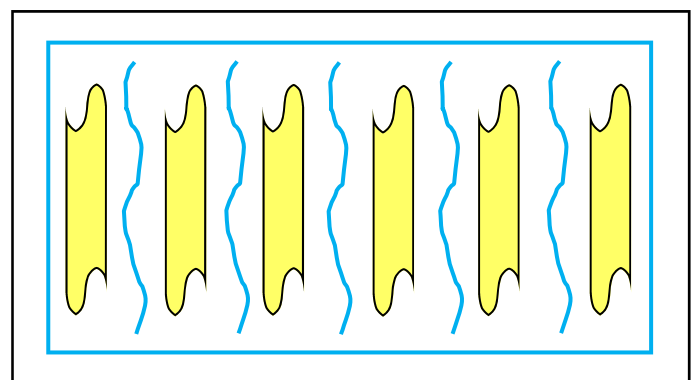
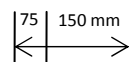

HSEA Spray █ Construction Adhesive █ Glue Guide

# CLOUD PANEL INSTALLATION GUIDE

## SPIRAL ANCHOR for frameless panels



asona

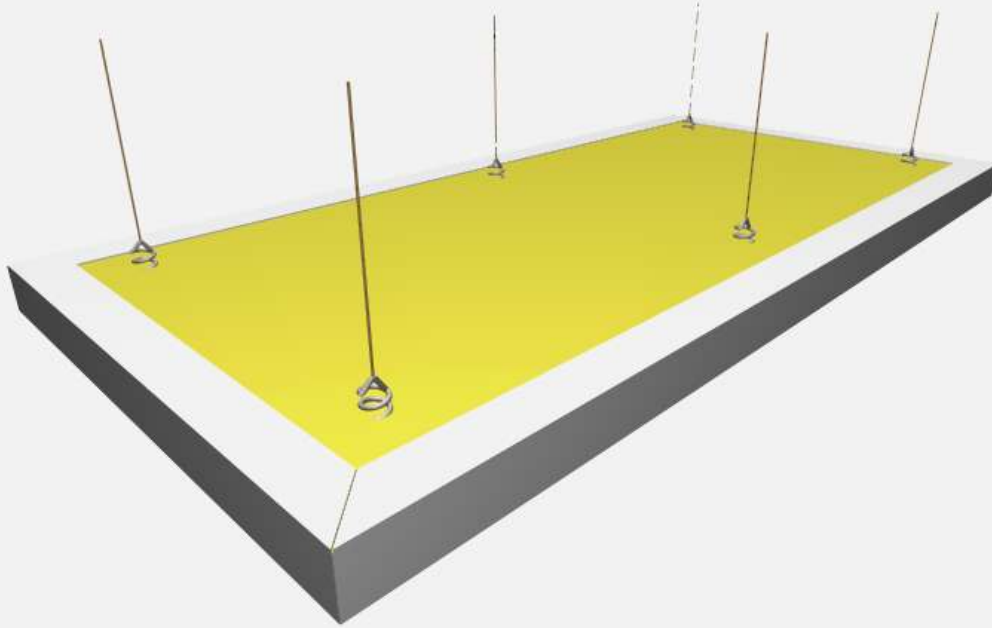

The following guidelines are given to help avoid common errors. They are not intended to be a step-by-step list of instructions or a checklist, and it is assumed that the installer has general construction knowledge. Asona bears no responsibility for any installation actions taken or not taken, and is not responsible for installer selection.

### HANDLING & STORAGE

Handle individual panels 'on edge' to avoid bending when moving and carrying. Store panels on a flat, dry solid surface. Do not store on edge. Take necessary measures to keep panels dry, clean and free from dust. Pay special attention to edges. Use gloves when handling panels to avoid marking.

### INSTALLATION

1. Measure lines on ceiling keeping lines plumb and square to create panel anchor locations on the ceiling.
3. Spiral anchors are designed to be anchor points on the panel for the connector clip to attach to.
4. Screw the spiral anchors to the panel, 50 - 100 mm in from all four edges of the panel (for circular panels equally space the anchors in a formation within the circumference.

5. Use the following guide to determine the number of anchors needed per panel:

<b>Width</b>	600mm	1000mm	1200mm	1200mm
<b>Height</b>	1000mm	1200mm	1800mm	2400mm
<b>Anchors</b>	4	4	6	6

6. Install the top-cap or top loop into the ceiling substrate.

7. Attach the connector clips (with their attached hanging wire) to the anchors on the panel.

8. Connect the wire to the top-cap or hook and using the adjustable clip connector raise the panel up to the required hanging height. NB: The panel must be supported until all 4, 6, 8 hanging wires are attached and at the desired height.

9. Measure off and adjust height accordingly until all panels are aligned with each other..

**NB:** Cloud Panel tolerance is +/- 3mm. Do not butt-up panels on all four sides, we recommend a minimum gap between panels when installed.

Contact Asona for ceiling applications on:  
09 525 6575 or [info@asona.co.nz](mailto:info@asona.co.nz)

# CLOUD PANEL INSTALLATION GUIDE

## FIXING PLATES for frameless panels



asona

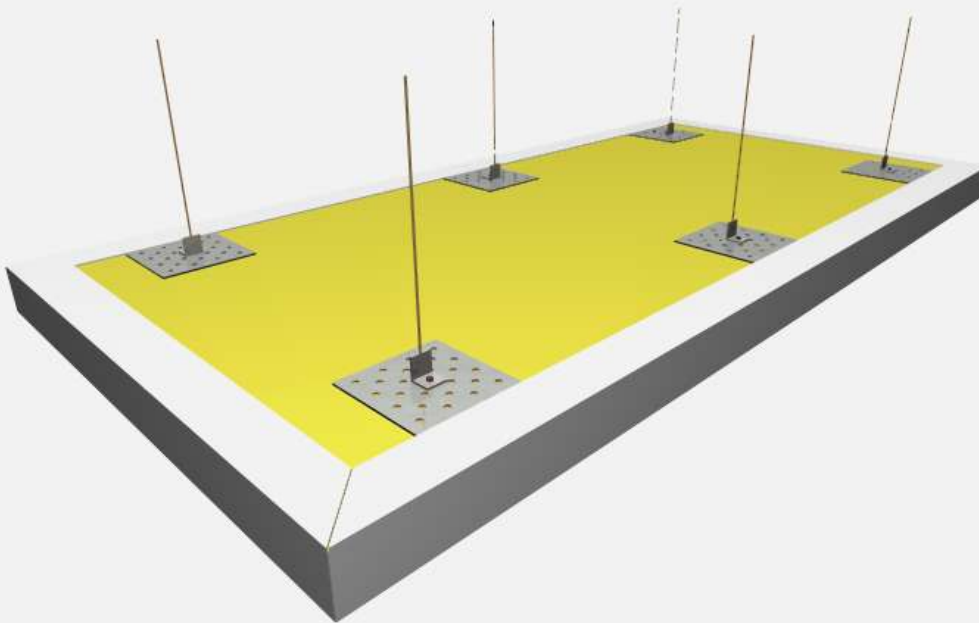

The following guidelines are given to help avoid common errors. They are not intended to be a step-by-step list of instructions or a checklist, and it is assumed that the installer has general construction knowledge. Asona bears no responsibility for any installation actions taken or not taken, and is not responsible for installer selection.

### HANDLING & STORAGE

Handle individual panels 'on edge' to avoid bending when moving and carrying. Store panels on a flat, dry solid surface. Do not store on edge. Take necessary measures to keep panels dry, clean and free from dust. Pay special attention to edges. Use gloves when handling panels to avoid marking.

### INSTALLATION

1. Measure lines on ceiling keeping lines plumb and square to create panel anchor locations on the ceiling that match the location of the fixing plates on the panels.
3. Fixing plates are designed to be anchor points for brackets to be screwed too. The panels will come with fixing plates already attached.
4. Screw the brackets to the fixing plates.

5. The number of fixing plates per panel guide:

<b>Width</b>	600mm	1000mm	1200mm	1200mm
<b>Height</b>	1000mm	1200mm	1800mm	2400mm
<b>Fixing plates</b>	4	4	6	6

6. Install the top-cap or top loop into the ceiling substrate.

7. Attach the connector clips (with their attached hanging wire) to the brackets on the panel.

8. Connect the wire to the top-cap or hook and using the adjustable clip connector raise the panel up to the required hanging height. NB: The panel must be supported until all 4, 6, 8 hanging wires are attached and at the desired height.

9. Measure off and adjust height accordingly until all panels are aligned with each other..

**NB:** Cloud Panel tolerance is +/- 3mm. Do not butt-up panels on all four sides, we recommend a minimum gap between panels when installed.

Contact Asona for ceiling applications on:  
09 525 6575 or [info@asona.co.nz](mailto:info@asona.co.nz)

# CLOUD PANEL INSTALLATION GUIDE

## BRACKETS on framed panels



asona

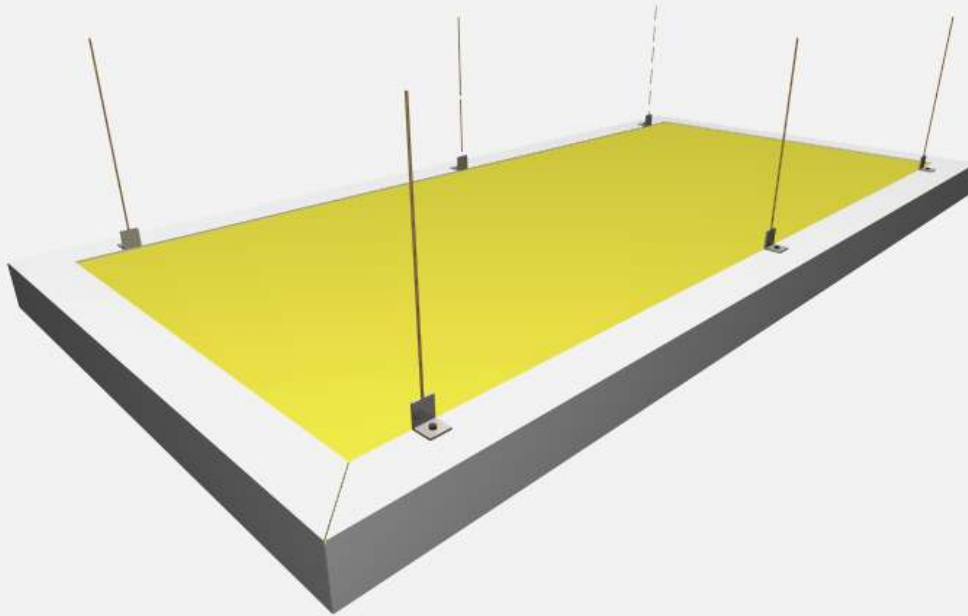

The following guidelines are given to help avoid common errors. They are not intended to be a step-by-step list of instructions or a checklist, and it is assumed that the installer has general construction knowledge. Asona bears no responsibility for any installation actions taken or not taken, and is not responsible for installer selection.

### HANDLING & STORAGE

Handle individual panels 'on edge' to avoid bending when moving and carrying. Store panels on a flat, dry solid surface. Do not store on edge. Take necessary measures to keep panels dry, clean and free from dust. Pay special attention to edges. Use gloves when handling panels to avoid marking.

### INSTALLATION

1. Measure lines on ceiling keeping lines plumb and square to create panel anchor locations on the ceiling that match the location of the brackets on the panels.
3. Brackets are designed to be anchor points on the panel.
4. Screw the brackets to the panels concealed metal frame from all four corners of the panel (and along the long edges if panel size requires it.)

5. Use the following guide to determine the number of brackets needed per panel:

<b>Width</b>	600mm	1000mm	1200mm	1200mm
<b>Height</b>	1000mm	1200mm	1800mm	2400mm
<b>Brackets</b>	4	4	6	6

6. Install the top-caps or top loop into the ceiling substrate.
7. Attach the connector clips (with their attached hanging wire) to the brackets on the panel.
8. Connect the wire to the top-cap or hook and using the adjustable clip connector raise the panel up to the required hanging height. NB: The panel must be supported until all 4, 6, 8 hanging wires are attached and at the desired height.
9. Measure off and adjust height accordingly until all panels are aligned with each other..

**NB:** Cloud Panel tolerance is +/- 3mm. Do not butt-up panels, we recommend a minimum gap between panels when installed.

Contact Asona for ceiling applications on:  
09 525 6575 or [info@asona.co.nz](mailto:info@asona.co.nz)