

sonacoustic™

SEAMLESS ACOUSTIC FINISH



TECHNICAL DATA SHEET - BPIR CLASS 2



Seamless acoustic finish

Technical Data Sheet - BPIR Class 2

Sonacoustic™ is a high sound absorbing seamless acoustic finish designed for flat or curved ceilings as well as high level wall surfaces above 2m. Sonacoustic is applied on site over a solid lining, trowelled and sanded to a smooth finish.

Application

Sonacoustic™ is an ideal solution for auditoria, atriums, art galleries, conference centres, foyers, high end housing, hotels, museums and offices that require an acoustic treatment with a monolithic appearance.

Composition

The Sonacoustic™ system consists of Sonagluce, Sonaboard glass wool absorber, Sonacoustic base coat plaster and Sonacoustic finish coat plaster.

Features & Benefits

- Seamless plaster like finish for a monolithic appearance.
- High sound absorption for control of reverberation. NRC 0.80—0.90. Available in thickness up to 65 mm for superior low frequency absorption.
- Ideal solution for high profile, large volume and irregular shaped spaces that need broad band acoustic treatment.
- Hand formed to flat and curved surfaces.
- Damage to surface can be spot repaired and sanded out.
- Fire Group 1-S, ISO A2 classification.
- Available in white, special colours to order.
- Contains natural cellulose fibre from renewable resource.
- Lightweight, can be applied to common interior surfaces, plasterboard, concrete, metal.
- Installed by qualified trades.
- Fine texture or sanded to smooth finish.

Sonacoustic Absorption Coefficients

NZ	125	250	500	1000	2000	4000	NRC	αw
PL 25 mm	0.15	0.45	0.80	0.95	0.95	0.85	0.80	0.75
PL 30 mm	0.20	0.60	0.90	0.90	0.80	0.70	0.80	0.80
PL 35 mm	0.25	0.65	0.90	0.95	0.90	0.90	0.85	0.90
PL 45 mm	0.40	0.80	0.95	0.95	0.90	0.90	0.90	0.95
PL 56 mm	0.80	0.90	1.10	0.80	0.70	0.80	0.80	0.90
PL 65 mm	0.70	0.95	0.90	0.90	0.85	0.85	0.90	0.90

Colour:

White, special colours to order, consult Asona.

Maintenance:

Dry clean using a soft bristled brush or vacuum to remove surface dust. The surface may also be lightly sanded to remove marks. Do not use wet cleaning methods.

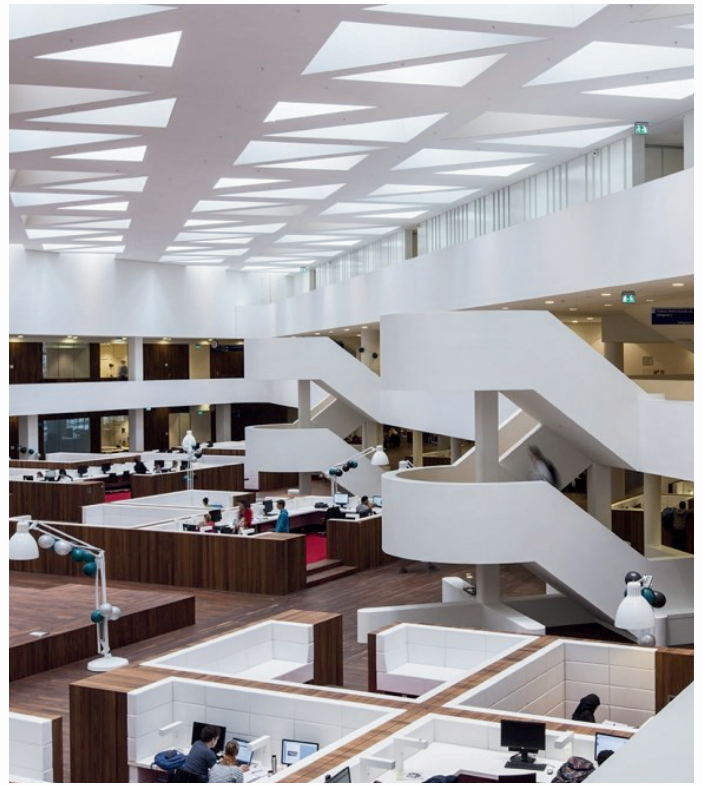

Limitations:

- Not for use in external applications, wet areas, or in contact with moisture.
- Maximum humidity/temperature 90% R/H at 30°C.
- For application to ceilings, and high level walls, above 2m.
- Sonacoustic is a hand applied system and sensitive to the skill of the applicator to achieve a smooth finish.
- Not suitable in critical lighting conditions unless surface variance is acceptable.

NZ Building Act

This product is not subject to a warning or ban under Section 26.

NZ Building Code Compliance:

- B2 Durability – Clause B2.3.1 (c) (i): Sonacoustic with only normal maintenance will have a minimum durability of at least 5 years when installed in accordance with; manufacturer’s installation requirements.
- C3 Fire – Clause C/AS2 3.4(a): Sonacoustic has a Fire Material Group Number 1-S (A2-s1) by MBIE Building Performance Surface Finishes Standards Comparison 2938, 01 March 2015, in accordance with EN 13501-1:2002.

Warranty:

15 year limited warranty against manufacturing defects.

Installation: Sonacoustic PL over plasterboard

Shall not commence until the building is water tight and dry.

1. Prepare area, install aluminium perimeter trims and M/E penetrations.
2. Apply Sonagluce to back of Sonaboard glass wool panels and glue fix to plasterboard ceiling lining.
3. Sand Sonaboard joins and surface to remove high points.
4. Spray apply Sonacoustic base plaster, trowel smooth and allow 3-5 days to dry thoroughly.
5. Spray apply Sonacoustic finish plaster, trowel smooth, allow 3-4 days to dry.
6. Sand with 180-220 grit for a smooth fine texture finish.

Specification:

Acoustic finish shall be Sonacoustic PL as supplied by Asona Ltd, Tel:09 525 6575, info@asona.co.nz. (ceiling) (wall) PL ()mm, Fire Group 1-S, NRC (0.80) (0.85) (0.90). Installed by approved applicator. (Asona Masterspec specification available).