

Triton Cloud Panel™ - NRC 1.00

Edge Wrapped 'Floating' Acoustic Panel

Technical Data sheet



SONO

Description.

Triton Cloud Panel™ is a proprietary high sound absorbing glass fibre panel laminated and edge wrapped with Sonatex™ acoustic laminate facings. Available in a broad range of colours, sizes and shapes from rectangles, trapezoid, triangles, hexagonal and circles.

Application.

Triton Cloud Panel™ is designed as a free floating acoustic ceiling panel or direct fixed ceiling & wall panel. Ideal for open plan offices, meeting rooms, receptions, restaurants, retail, schools, halls and banks.

Composition.

Manufactured in NZ, from bio-soluble glass fibre core, reinforced edges with optional concealed metal frame, Sonatex™ acoustic laminate facings, woven glass fabric or decorative polyester or wool fabric finishes.

Benefits.

- High sound absorption, NRC 1.00, class A, α_W 1.0
- Design freedom with a broad range of decorative acoustic laminate finishes, sizes, thicknesses and shapes
- Wrapped composite reinforced edges provide a clean frameless look with option of concealed metal reinforced edges where screw fixing is desired.
- Easy to use adjustable suspension kits with spiral anchor
- Dimensionally stable in high humidity, special version available for use in swimming pool applications
- Core from 80% recycled post consumer content
- Width 1200mm max, length to 3000mm subject to type.
- *GreenTag certified / Level A (Sonatex, Frameless, Aluminium Edge), Level B (Sonatex, Frameless, Steel Edge), Level C (Beehive & Woven Image fabric ranges only).

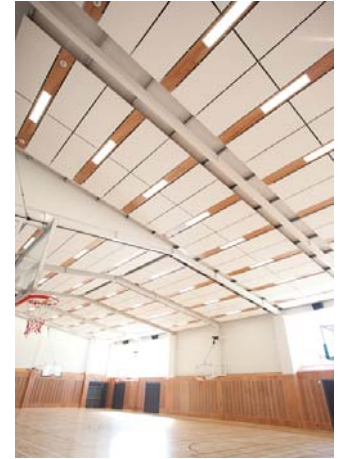

Technical Specifications

Sound Absorption Rating:						
50 mm panel, Test reports T0601-2, α_W 1.0; NRC 1.00 per ASTM C423, E-200 mounting						
T0601-5, A-mount, α_W 1.0; NRC 1.00						
Hz	125	250	500	1000	2000	4000
α_p E200	0.70	1.00	1.00	1.00	1.00	0.95
α_p A	0.25	0.85	1.00	1.00	0.95	0.90



Sonatex glass composite finish



Woven glass fabric finish



Decorative fabric finish



* see restrictions above

Technical Specifications

Sizes:

Thickness: 25, 40, 50, 75, 100mm
 Width: 600, 900, 1000, 1200mm subject to Cloud Panel facing.
 Length: 600, 900, 1000, 1200, 2000, 2400, 2700, 3000 mm

Note: Thickness and selected finish will influence the maximum size, please consult with Asona Ltd prior to specification

Back loading:

Max. 1.5 kg/m², point loads shall be independently supported.

Weight:

2 to 5 kg kg/m² subject to thickness and density selected

Colour:

Sonatex: (White A180) (Mid Grey RAL7040) (Light Grey RAL7030) (Grey White RAL9002) (Wood Wool Print) (Plaster Print) (Wood Print over RAL1014 Oak) (Wood Print over RAL1013 Blond) (Wood Print over RAL8019 Walnut) (Zinc Yellow RAL1018) (Ivory RAL1014) (Graphite Black RAL9011) (Traffic Red RAL3020) (Orient Red RAL3031) (Traffic Orange RAL2009) (Traffic Green RAL6032) (Aqua RAL6027) or (1963 White Glass Woven Fibre Fabric) or standard fabric ranges. Other colours and fabrics to order.

NB: Digitally printed images on to fabric must be either a single image per panel or there must be a negative reveal of 10mm (min) between panels if the image is to run across several panels.

Environmental impact:

From 80% recycled content, low embodied energy, damaged or soiled panels can be reused/ resurfaced with new acoustic facing to reduce construction waste and costs. Low VOC.

Fire Reaction:

Material group number: 1S (highest rating) C/VM2 / ISO 5660.1. Suitable for fire exit way and all other sprinklered & non sprinklered buildings. NB: Use of certain fabrics may effect the fire rating, please consult Asona.

Humidity:

Non hygroscopic, dimensionally stable, resists fungi and stains. Max 99% R/H at 45°C.

Light reflectance:

ASTM C1477 LR-1, >82% White

NZ Building Code:

Clause B2—durability, 5 years

Maintenance:

Clean with vacuum, soft brush or damp cloth. Re-surfacing of soiled panels available, consult Asona.

Service Panels:

Available with protective plastic film covering which will help keep panels cleaning during installation of M/E services.

Thermal Resistance:

R 1.47 m²°C/W (50 mm panel)

Tolerance:

Width & Length +/- 3 mm

Installation:

Shall not commence until the building is water tight and dry. Light/mechanical fittings shall be independently supported, place mounting board at rear of panel to integrate fixtures. Mount panels on adjustable hanger wire or direct fix brackets @ 1200 centres. Sub-trades not to use panels for support.

Specification:

Acoustical panels shall be Triton Cloud Panel, from glass fibre core, shape shall be (rectangle) (trapezoid) (triangle) (Hexagon) (circle) with composite reinforced edges (optional metal reinforced edges) laminated and wrapped in (Sonatex acoustic laminate finish) (colour) (1963 White woven glass fabric)(selected Fabric) finish to face and edges. item # (), module () x ()mm (40)(50)(75)(100) mm thick, sound absorption Class A, αW 1.0, NRC 1.00, thermal insulation R1.47, fire group: 1S, colour () or fabric(). Suspend panels via (spiral anchor with adjustable hanger)(direct fix brackets) fixings @ 1200mm centres. Manufactured by Asona Ltd tel: 09 525 6575, info@asona.co.nz

Fixing Options

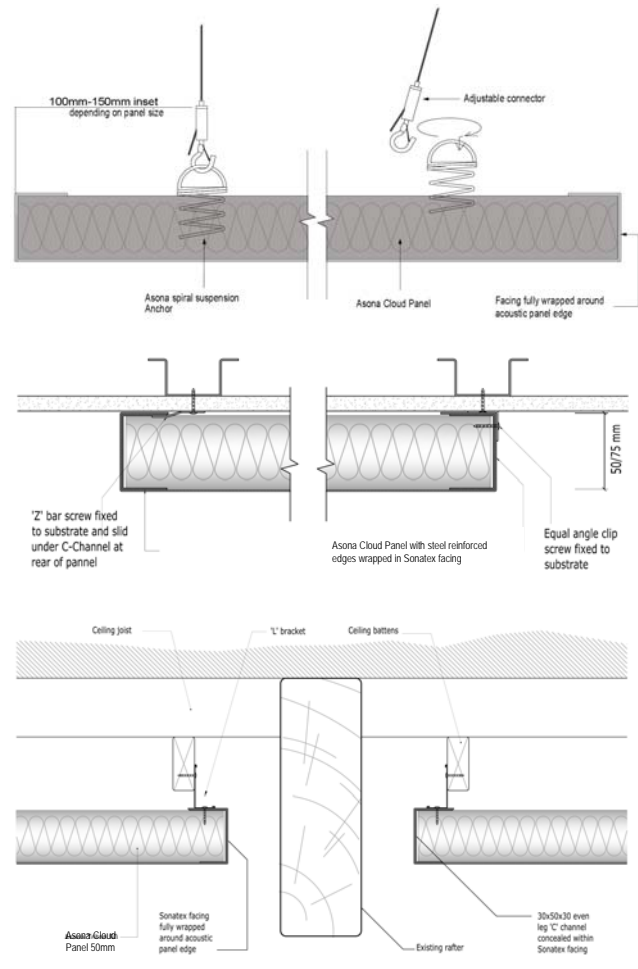

Asona Ltd

P.O Box 96-241 Balmoral,
 Auckland, New Zealand
 Tel: 09 525 6575
 Email: info@asona.co.nz
 Web: www.asona.co.nz

Factory:
 Building 12-16, 7 Cain Rd,
 Penrose, Auckland,
 New Zealand
 Tel: (09) 525 6575

Triton Cloud Sound Shapes™

Shaped Acoustic Panels. NRC 1.00

Technical Data sheet



SONO

Description.

The Sound Shapes™ range was developed as a response in the market for more free-form suspended and direct fixed acoustic panels that could work in unconventional spaces. Sound Shapes™ are high sound absorbing glass fibre ceiling clouds designed to work together in formations and clusters to control unwanted noise & reverberation. The panels can be direct fixed to the lining or suspended individually or in clusters on a frame.

Application.

The Sound Shapes™ panels are ideal for receptions, meeting rooms, quiet rooms, showrooms, galleries, retail spaces, offices and hospitality.

Composition.

Made in NZ from 80% recycled bio-soluble glass fibre core, laminated with Sonatex™ composite or white woven glass fabric or other fabric wrapped finishes.

Benefits.

- Adds drama and ceiling focal point to interiors.
- High NRC sound absorption rating for control of reverberation.
- Light weight, non combustible and dimensionally stable.
- Available in a wide range of colours, wood-grain print and fabric finishes.
- The Sound Shape range can be clustered and mixed & matched together to form exciting organic formations.
- Highly decorative and versatile to accommodate technically challenging spaces.
- 80% recycled glass core, low in FOC and Group 1S fire rating (Fabric wrapped panels will be Group 2 dependant upon fabric used)
- Direct fixed to linings, suspended individually or set on a frame.
- GreenTag Certified / Level A



Shape	Large Size	Standard Size
Triangle	40x1100x715mm max	40x815x530mm
Pentagon	40x1100x1050mm max	40x510x480mm
Octagon	40x1080x1000mm max	40x570x530mm
Hexagon	40x1170x1015mm max	40x670x580mm
Rhomboid	40x1180x900mm max	40x620x530mm
Diamond	40x1180x1000mm max	40x620x530mm
Circle	40x1170mm dia. max	40x600mm dia.

NB: Cloud shape must not exceed maximum sizes indicated.



Technical Specifications

Finishes:

Sonatex: (White AS180) (Mid Grey RAL7040) (Light Grey RAL7030) (Grey White RAL9002) (Wood Wool Print) (Plaster Print) (Wood Print over RAL1014 Oak) (Wood Print over RAL1013 Blond) (Wood Print over RAL8019 Walnut) (Zinc Yellow RAL1018) (Ivory RAL1014) (Graphite Black RAL9011) (Traffic Red RAL3020) (Orient Red RAL3031) (Traffic Orange RAL2009) (Traffic Green RAL6032) (Aqua RAL6027) or (1963 White Glass Woven Fibre Fabric), other finishes to order.

Environmental impact:

Core from 80% recycled local waste glass, product and packaging can be reused/recycled in NZ.
Low VOC <0.002 Mg/M²/hr per ASTM D5116

Fire Reaction:

Sonatex & Glass Woven Fabric Group 1S. C/VM2 / ISO 5660.1. NB: Polyester, wool fabric wrapped panels will be Group 2 dependant upon fabric used.

Humidity:

Max 90% R/H at 45°C.

Light reflectance:

ASTM C1477 LR-1, >75% White

Maintenance:

Clean with vacuum, soft brush or damp cloth. Re-surfacing of soiled panels available, consult Asona.

NZ Building Code:

Clause B2—durability, 5 years

Weight:

3.75 kg/m²

Tolerances:

Less than +/-3mm per panel

Installation:

Triton Cloud Sound Shapes™ range is a finishing trade, installation shall not commence until the building is water tight, dry and free of dust and debris. Direct fix or suspend using cloud suspension kits.

Specification:

Acoustic panels shall be Asona Triton Cloud Sound Shapes™ panels as manufactured and supplied by Asona Ltd Tel: 09 525 6575, item # (), size shall be () x ()mm, thickness shall be 40 x () x ()mm, finish shall be Sonatex: (White AS180) (Mid Grey RAL7040) (Light Grey RAL7030) (Grey White RAL9002) (Wood Wool Print) (Plaster Print) (Wood Print over RAL1014 Oak) (Wood Print over RAL1013 Blond) (Wood Print over RAL8019 Walnut) (Zinc Yellow RAL1018) (Ivory RAL1014) (Graphite Black RAL9011) (Traffic Red RAL3020) (Orient Red RAL3031) (Traffic Orange RAL2009) (Traffic Green RAL6032) (Aqua RAL6027) or (1963 White Glass Woven Fibre Fabric). Sonatex Cloud panels shall be delivered to site with protective plastic film coating that is to be removed on installation.

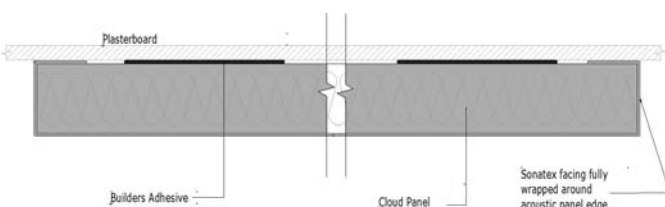
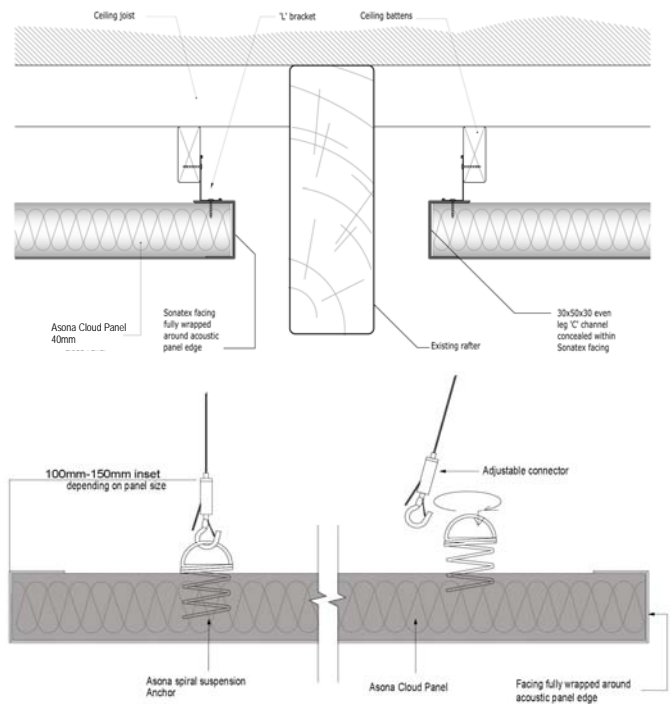

Asona Ltd

P.O Box 96-241 Balmoral,
Auckland, New Zealand
Email: info@asona.co.nz
Web: www.asona.co.nz

Factory:
Building 12-16, 7 Cain Rd,
Penrose Auckland,
New Zealand
Tel: (09) 525 6575

ISO 9001:2008 Registered Firm No. NZ1014

© Copyright ASONA Ltd 2018
Asona, Cloud Sound Shapes, Sonatex are trade marks of Asona Ltd
All dimensions are nominal. We reserve the right to change specifications.
Ref. Cloud Sound Shapes—1809