

Triton Pool Panel™ - NRC 1.00

High Sound Absorbing Ceiling Panel for Swimming Pools.

Technical Data sheet



asona

Description.

Triton Pool Panel™ is a proprietary edge wrapped 50 mm thick high sound absorbing acoustical panel designed for high level swimming pool ceilings. The back of the panel is laminated with a impermeable foil, edges reinforced with a concealed aluminium frame then laminated and edge wrapped in silicon treated Sonatex glass mat acoustic facing.

Application.

Triton Pool Panel™ is designed as a free floating acoustic ceiling panel or direct fixed ceiling & wall panel. Specifically designed for swimming pools.

Composition.

Manufactured in NZ, from bio-soluble glass fibre core, aluminium framed, wrapped in 2 ply Sonatex™ glass mat composite finish sprayed with water repellent and with a foil backer.

Benefits.

- Glass fibre core provides very high sound absorption, NRC 1.00, ISO 11654 class A, α_W 1.0.
- Clean wrapped edges with concealed framing eliminates the unsightly edge framing common with other panels .
- High light reflectance in standard white, colours available
- Available in standard or custom sizes.
- Concealed aluminium frames for strength.
- Dimensionally stable in high humidity.
- Made in NZ, low embodied energy, 80% recycled content
- Designed specifically for swimming pool environments.
- Water repellent surface.
- *GreenTag certified / Level A (Sonatex, Frameless, Aluminium Edge), Level B (Sonatex, Frameless, Steel Edge), Level C (Beehive & Woven Image fabric ranges only).



Technical Specifications

Sound Absorption Rating:						
ISO 354 E-200 α_W 1.0; NRC 1.00 per ASTM C423						
Test reports T0601-2, T0601-5						
Hz	125	250	500	1000	2000	4000
α_p E200	0.70	1.00	1.00	1.00	1.00	0.95
α_p A	0.25	0.85	1.00	1.00	0.95	0.90

Fixing Option

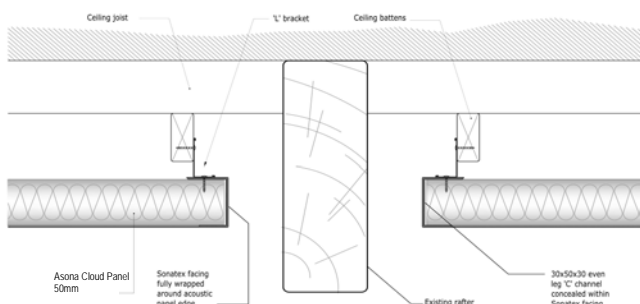

* see restrictions above

Technical Specifications

Sizes:

Thickness: 50mm
Width: 600, 900, 1000mm
Length: 600, 900, 1000, 1200, 2000, 2400, 2700, 3000 mm
Other sizes to order, please consult Asona Ltd.

Back loading:

Max. 1.5 kg/m², point loads shall be independently supported.

Colour:

White, Grey(RAL7040), Black(RAL9011), Other colours to order.

Environmental impact:

From 80% recycled local content, low embodied energy, damaged or soiled panels can be reused/ resurfaced with new acoustic facing to reduce construction waste and costs. Low VOC.

Fire Reaction:

Material group number: 1S (highest rating) C/VM2 / ISO 5660.1. Suitable for fire exit way and all other sprinklered & non sprinklered buildings.

Humidity:

Max 99% R/H at 45°C. Face not designed for direct contact with water. Control humidity to prevent condensation.

Light reflectance:

ASTM C1477 LR-1, >75% White

NZ Building Code:

Clause B2—durability, 5 years

Maintenance:

Clean with vacuum, soft brush or damp cloth. Re-surfacing of soiled panels available, consult Asona.

Service Panels:

Available with protective plastic film covering which will help keep panels cleaning during installation of M/E services.

Thermal Resistance:

R 1.47 m²°C/W

Weight:

3 kg/m²

Installation:

Shall not commence until the building is water tight and dry. Light/mechanical fittings shall be independently supported, place mounting board at rear of panel to support fixtures. Mount panels on hanger wire or direct fix brackets @ 1200 centres. Sub-trades not to use panels for support. Panels shall be installed in areas free of direct contact with water or water vapour including but not limited to condensation, leaking pipes and/or ducts or steam which can lead to staining.

Specification:

Acoustical treatment shall be Triton Pool Panel from a glass fibre core, (reinforced edges) or (frameless) wrapped in (2 ply Sonatex glass mat composite)(1963 White woven glass fabric) (Fabric) finish to face and edges as manufactured by Asona Ltd tel: 09 525 6575, item # (), module () x ()mm, (40)(50) (75)(100) mm thick, sound absorption Class A, αW 1.0, NRC 1.00, thermal insulation R1.47, fire group: 1S, colour (white) (RAL7040 grey)(RAL9011 black)(1963 textured white)(fabric) (other). Mount panels to structure via(suspension wire), (direct fix brackets) fixings @ 1200mm centres. Supply service panels with protective strippable plastic film facing.



Asona Ltd

P.O Box 96-241 Balmoral,
Auckland, New Zealand
Sales:
Tel: 09 525 6575
Email: info@asona.co.nz
Web: www.asona.co.nz

Factory:
Building 14, 7 Cain Road
Penrose
Auckland, New Zealand
Tel: (09) 525 6575
Fax: (09) 525 6579